

1 IMPORTANT! REGISTER KIT:

- Register kit at crlclear.com. The lab cannot process your sample unless it's registered.



2 COLLECTION PRECAUTIONS:

- DO NOT** eat, drink, smoke, brush teeth, or chew gum for 30 minutes before collecting saliva.
- DO NOT remove the plastic film from funnel lid.
- Should stabilizing liquid come into contact with eyes or skin, wash with water. DO NOT ingest.

3 PREP:

- Collection of saliva first thing in the morning is recommended, but not required.
- View the collection video at www.crlcorp.com/covid-19-testing/videos.
- IMPORTANT:** Wash your hands thoroughly for 20 seconds then dry your hands before starting the collection.

4 COLLECT: *Most people take between 2 and 5 minutes to deliver a sample following steps below.*

- Collect sample by closing mouth and sucking. Spit into funnel until the amount of liquid (not bubbles) reaches the fill line shown in picture #1. DO NOT overfill tube.
- Hold the tube upright with one hand. Close the funnel lid with the other hand (as shown) by firmly pushing the lid until you hear a loud click. The liquid in the lid will be released into the tube to mix with the sample. Make sure that the lid is closed tightly.
- Hold the tube upright. Unscrew the funnel from the tube.
- Use the small cap located in the plastic clamshell to close the tube tightly.
- Shake the capped tube for five seconds. Discard or recycle the funnel.
- IMPORTANT:** Wash your hands thoroughly for 20 seconds again, then dry your hands after completing the collection.

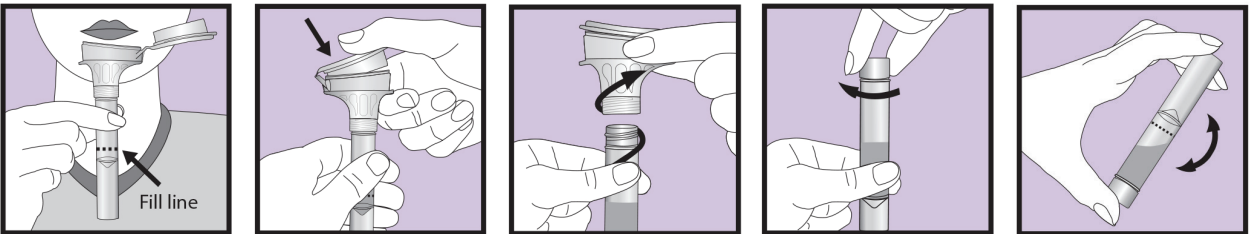

Saliva Collection Using OMNigene-ORAL® | OM-505 Device by DNA Genotek™

5 LABEL YOUR COLLECTION DEVICE:

- Write your first and last name on the barcode label. The name on the barcode label must match the name on your online registration.
- Affix barcode label to the saliva collection device as shown, after completing collection.
- Label placement should start below the cap with barcode number running down the tube.
- Tip:** Start at the arrow in front of the "F" in the word Fill and run the label around the tube.
- Note:** The label should not overlap. Testing may be delayed or not performed if tube is received unlabeled.

Remove Label Here

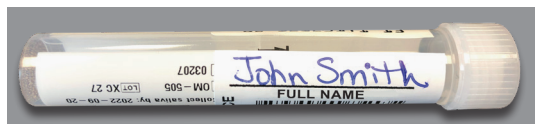

6 RETURN:



Before returning sample, you **MUST** register your kit at CRLCLEAR.COM.

- DO NOT return the funnel with the sample. Prior to shipping, the tube should be sealed with the small cap. Funnel and the clamshell that the device arrived in can be discarded.
- Place the saliva collection tube into the small pouch of the plastic zip top bag with the absorbent pad and seal the bag.
- Unless you have been provided with alternative return instructions, place sealed plastic zip top bag containing the sample and the absorbent pad into the original kit box provided and close the lid. Place the box that contains the sample inside the return shipping pouch and seal pouch. Place FedEx shipping label on exterior of shipping pouch.
- Shipment can be placed in any FedEx Drop Box or dropped at an approved FedEx location. Or, contact FedEx at 1-800-463-3339 to schedule a pickup. Specify you have a prepaid shipment for overnight delivery.

QUESTIONS: For additional information about COVID-19, visit www.crlcorp.com/covid-19-testing/faq.